

AGM3 Series

Sealed Aluminum Powder Coated
2x2 LED Highbay Luminaire



5 YEAR
WARRANTY

Designed and manufactured in Wisconsin from North American and Korean made components.

LED Design

- Utilizing latest LED technology from Samsung.
- Flip chip LED's mounted to metal board for reducing LED temperature and extending LED life.
- Plug and play system, designed for future LED upgrades and lumen maintenance.



Sealed Optics

- Optimizes light spread, reduces high lumen hot spots, directly underneath and eliminates LED glare.



Enclosure Design

- UL wet listed; single person installation.
- Designed to prevent birds from landing and building nests.
- Rigid mounted fixed brackets, prevents fixture movement from wind.
- Optional electrical insulation to isolate fixture from metal roofing.
- Fixture housing is designed to last and reuse at the end of LED life.
- Powder coated aluminum enhances heat transfer and is corrosion proof.

Nominal Electrical and Lumen spec's (164 l/w avg.)

- 75 watt ~ 12,000 lumens
- 100 watt ~ 16,000 lumens
- 150 watt ~ 25,000 lumens
- 200 watt ~ 33,000 lumens
- CRI>80, CCT 5000K
- 6kV combi-wave surge rating per ANSI C82.77-5 CAT C
- Simple 2-wire dimming with any normally open contacts; no need for an expensive dimming controller

Cone of Light Tabulation			
Mounting Height (feet)		Footcandles at Nadir	Diameter (feet)
12.0		50.1	17.4
14.0		36.8	20.3
16.0		28.2	23.2
18.0		22.3	26.0
20.0		18.1	28.9
23.0		13.6	33.3
26.0		10.7	37.6

AGM3 Series

Sealed Aluminum Powder Coated
2x2 LED Highbay Luminaire

Installation Instruction

1. Installers are responsible for following all local codes and ensuring a robust installation.
2. Make all electrical connections using UL listed components.
3. Electrical connections must be made by a qualified electrician and in accordance with NEC and local codes.
4. Space mounting brackets 27" apart with the large center hole facing down. *See Figure A.*
 - A. Use appropriate fasteners for the ceiling type. Installer is responsible for supplying and selecting the appropriate fastener
5. Install fixture by lifting the fixture up between the brackets and allowing the fixture hooks to enter each hook hole. *See Figure B.*
6. Adjust the angle of the fixture as desired.
7. Fasten fixture angle locking screws (provided).
 - A. Be sure to use a low torque setting.
8. Connect power per applicable codes and confirm proper operation.

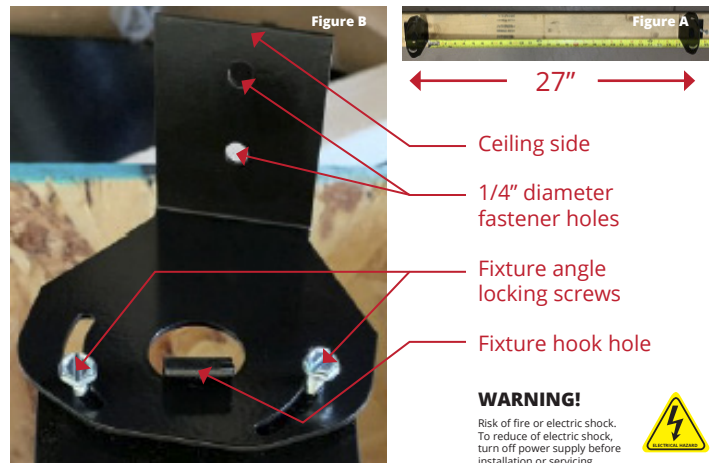

Ordering Examples (*All models are capable of dimming)

Series	Nominal Wattage	Voltage	Bracket	*Dimming Cord Option	Power Cord 5' Length
AGM3	75	120-277=UNV	Insulated=I	0-10V dimming=- 10VD	Cord= WW
	100	=480	Uninsulated= UL	No dimming cord= ND	Hardwire= HD (90 deg carflex)
	150				
	200				
AGM3	150	480	I	10VD	HD



To learn more, visit us on the web at
www.straightarrowenergy.us

(608) 558-4234 | straightarrowenergy@outlook.com

NOTE: All information is subject to engineering and/or other changes. All trade names are copyrighted.
© 2021 Straight Arrow Energy Consulting. All rights Reserved